

Drawing Notes

Parking Numbers:
 51 Staff (inc. 2 disabled)
 91 Patient (inc. 7 disabled)

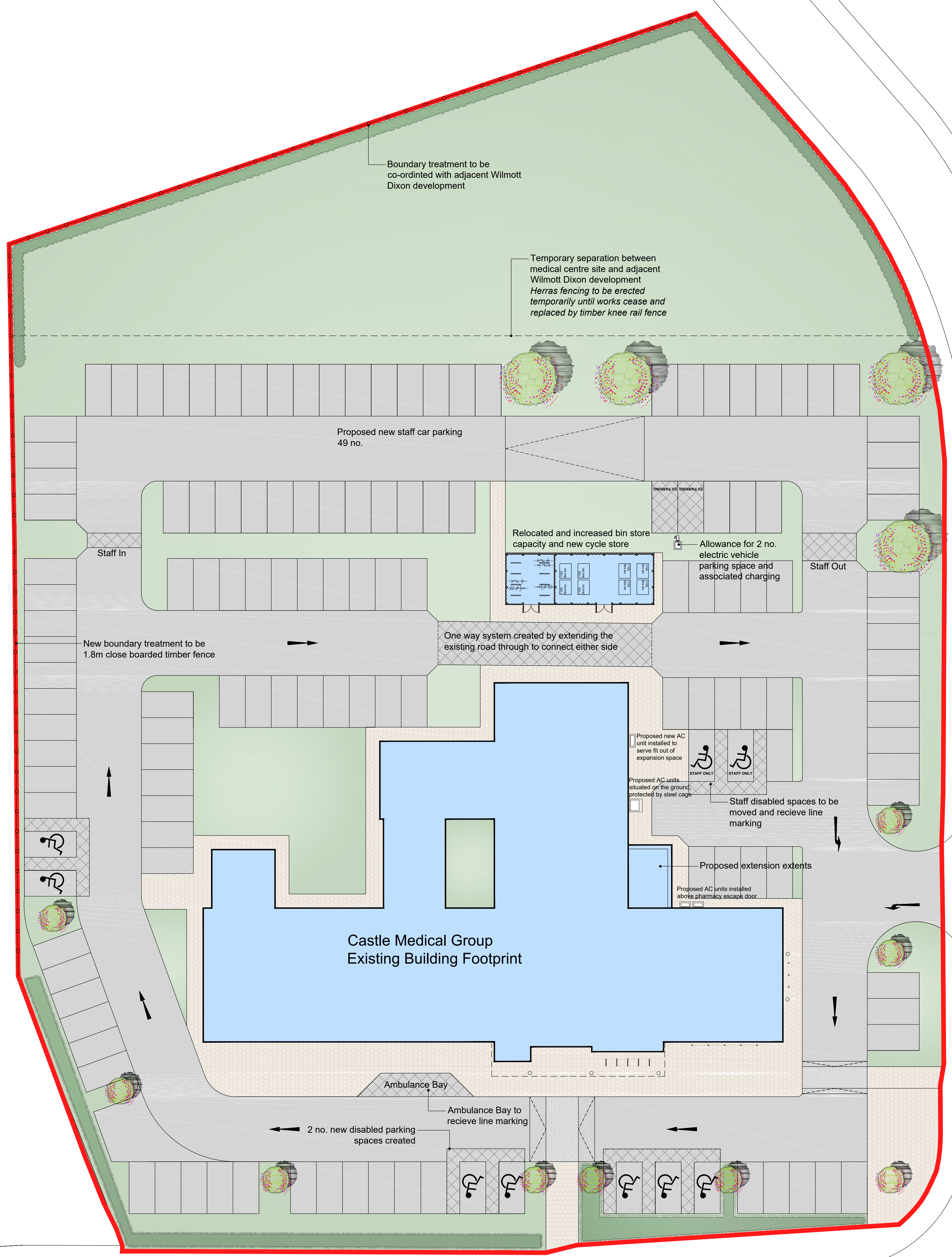

Boundary treatment to be co-ordinated with adjacent Wilmott Dixon development

Temporary separation between medical centre site and adjacent Wilmott Dixon development
 Herras fencing to be erected temporarily until works cease and replaced by timber knee rail fence

Proposed new staff car parking 49 no.

Relocated and increased bin store capacity and new cycle store

Allowance for 2 no. electric vehicle parking space and associated charging

New boundary treatment to be 1.8m close boarded timber fence

One way system created by extending the existing road through to connect either side

Proposed new AC unit installed to serve fit out of expansion space

Proposed AC units situated on the ground, protected by steel cage

Staff disabled spaces to be moved and receive line marking

Proposed extension extents

Proposed AC units installed above pharmacy escape door

Castle Medical Group Existing Building Footprint

Ambulance Bay

Ambulance Bay to receive line marking

2 no. new disabled parking spaces created

Burton Road

Rev Date Note

Status:
PLANNING



West Hart Partnership Ltd.
 Chartered Architects
 5 Aldergate,
 Tamworth,
 Staffs.
 B79 7DJ
 01827 67123
 post@westhart.com
 www.westhart.com

Client:
Assura

Project:
**Ascebi House,
 Ashby de la Zouch**
 Drawing title:
Proposed Site Plan

Drawing number:
1514-100
 Revision:
H

Date of first issue:
AUG. 2020
 Scale / Paper size:
1:200 / A1
 Drawn by / checked by:
BH / LB

Proposed Site Plan
 scale 1:200



This drawing and the building works depicted are the copyright of West Hart Partnership Ltd and may not be reproduced except by written permission. This drawing must be read and checked against any specialist drawings and information provided. Do not scale from this drawing when using this for construction purposes, use figured dimensions only. © West Hart Partnership Ltd 2014